



**LED Specialty Lighting**

**COKE OVEN EQUIPMENT**





**6" ROUND LED LIGHT**





## SATURN MACHINE & WELDING ENGINEERING SPECIFICATIONS

6F-LED-ROUND			
SPECIFICATIONS	INPUT VOLTAGE (Vdc)	DC 9~50V	
	AMPERAGE DRAW (A)	DC 12V	DC 24V
		5	2.5
	LED COUNT	6	
	WATTAGE (W)	60	
	LUMENS (lm)	5400	
	LENGTH (in)	7	
	HEIGHT (in)	6.75	
	DEPTH (in)	3.25	
	WEIGHT (lbs)	4.5	
	BEAM PATTERN	45 Degree Flood	
	COLOR TEMPERATURE (K)	7000	
	VIBRATION RATING (Grms)	8.6	
	OPERATING TEMPERATURE (F)	(-40 ~ 221)	
	IP RATING (IP)	68	
MATERIALS LIST	BODY	6061 Aluminum	
	FRONT COVER	6061 Aluminum	
	LENS	Soda Lime Glass	
	LENS COATING	IR Reflective	
	REFLECTOR	Metalized Polycarbonate	
	OPTICS	Acrylic	
	PC BOARD	Metal 1.6t	
	INPUT CONNECTOR (UNIT)	AI MS3101A14S-7PW	
	INPUT WIRING LEADS	538-4C18TFLMS-SS	
	INPUT CONNECTOR (WIRE)	AI MS3106A14S-7SW	
	LENS SEAL	2.0 Silicon Clear	
	MOUNTING BRACKET	3T IRON	
	MOUNT BUSHING	Bronze	

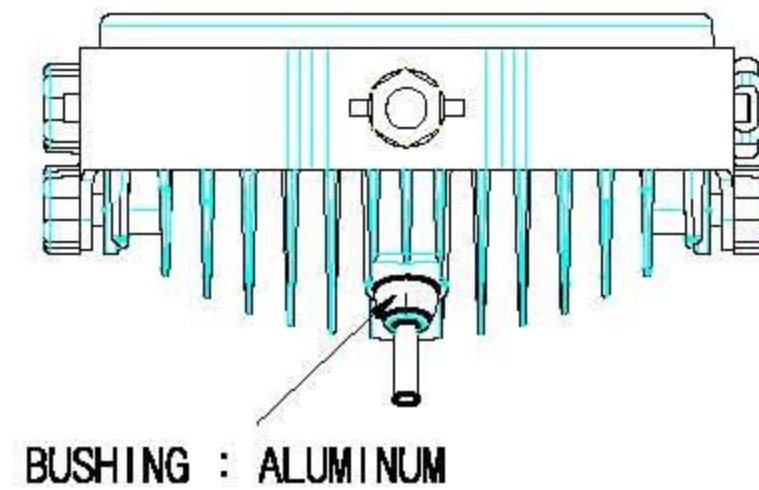
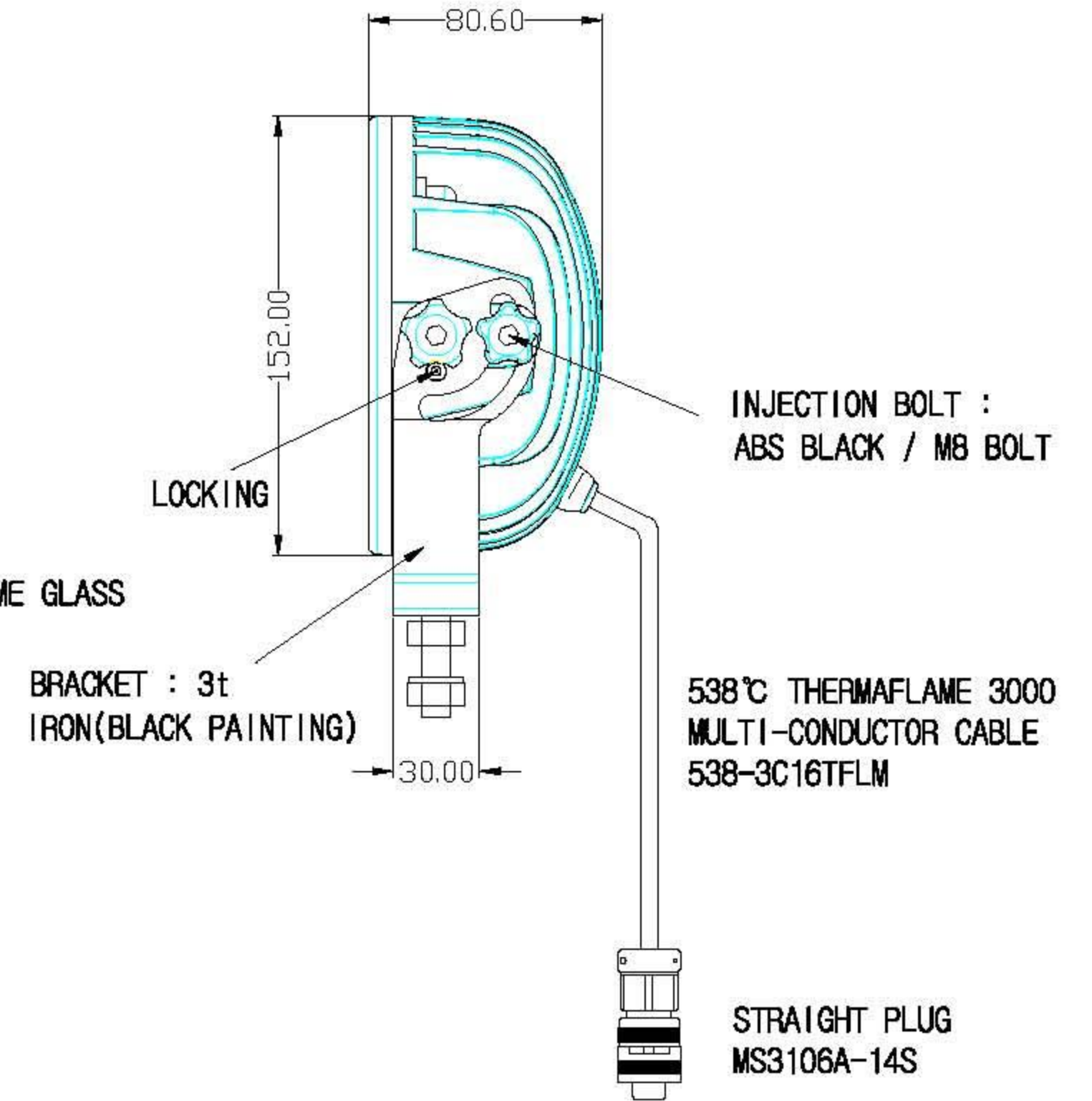
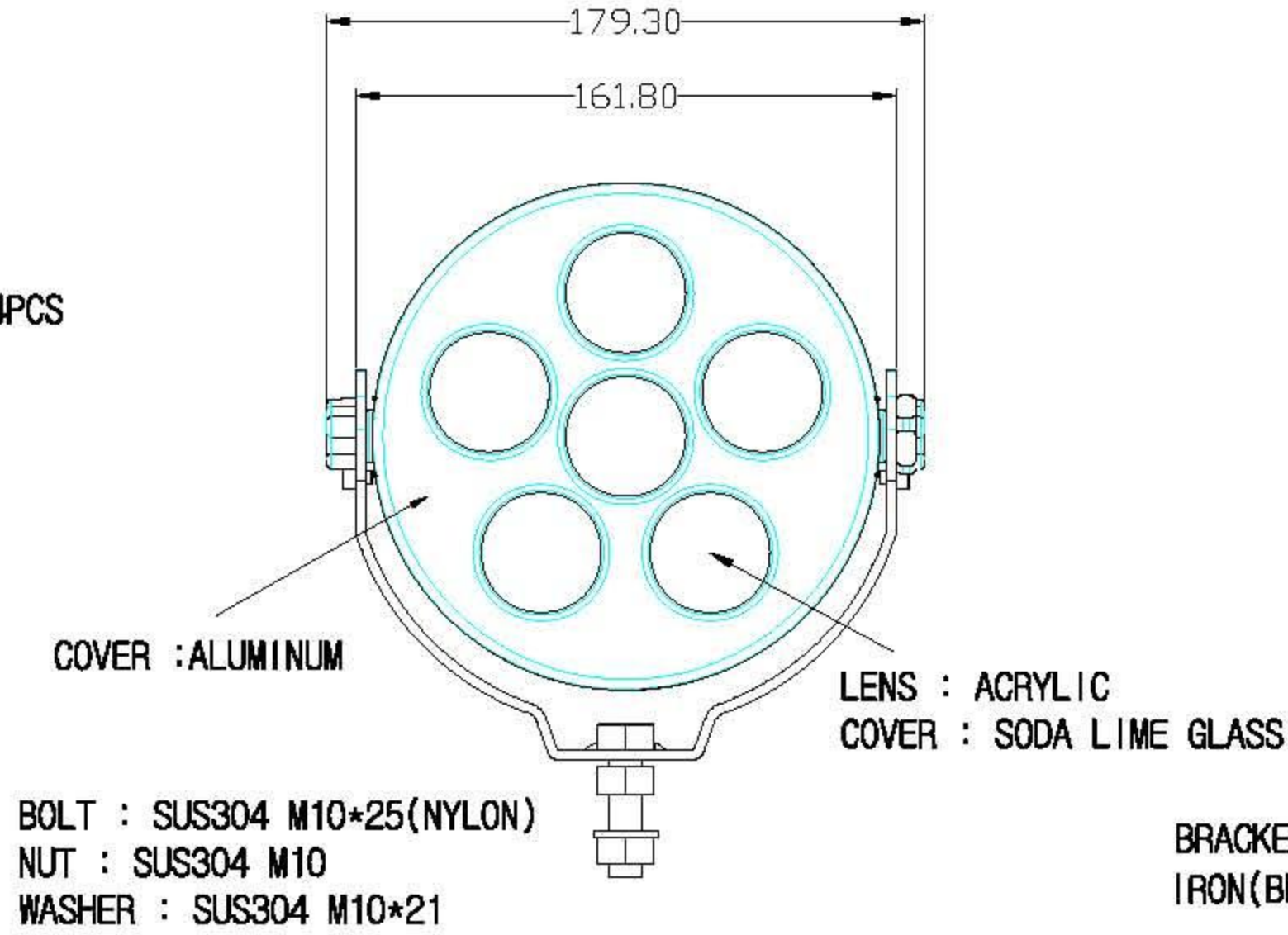
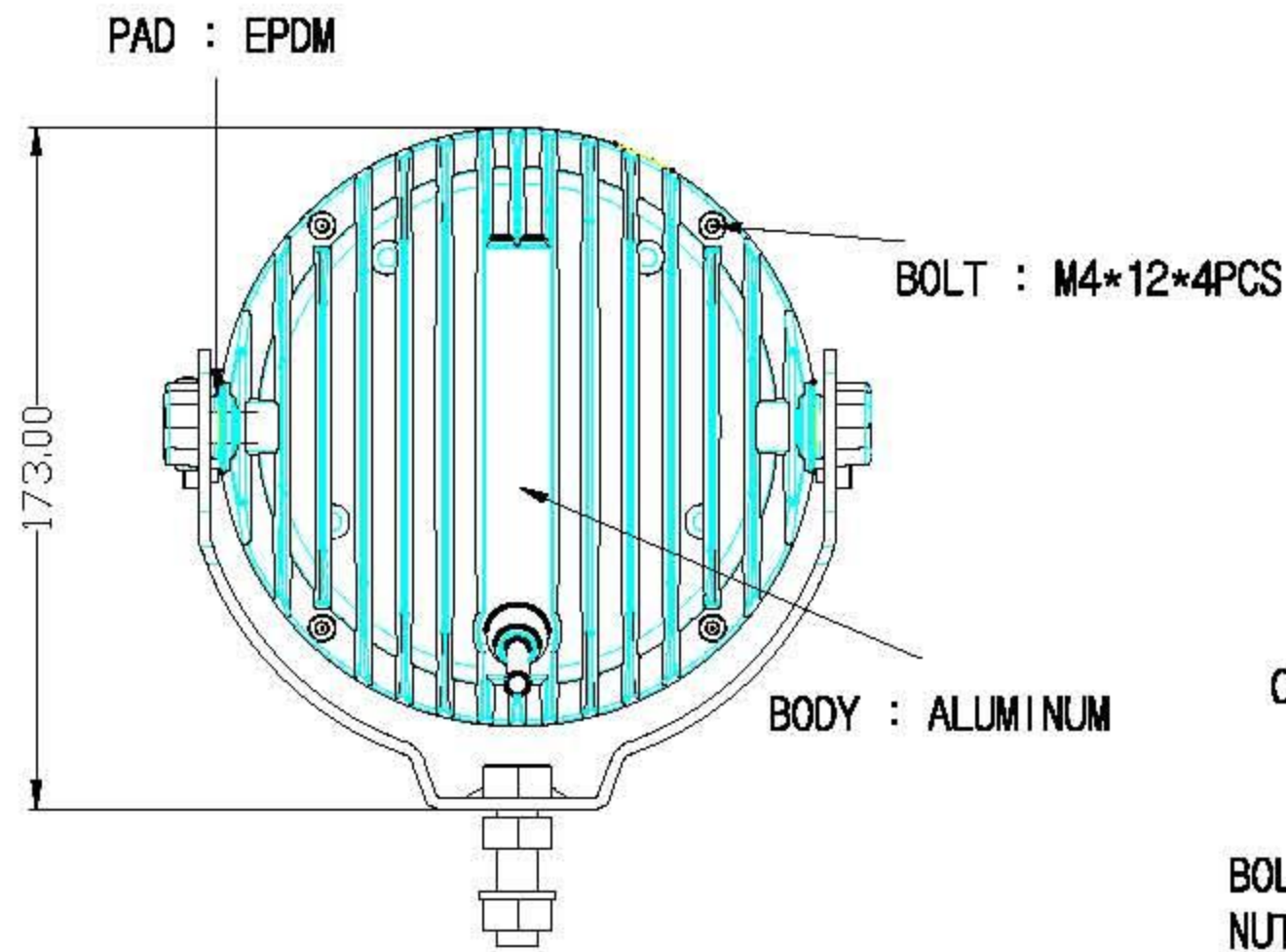

**SPECIFICATION**

1. OPERATING VOLTAGE : DC 9.0~50V
2. WATTAGE : 60W
3. LED : 10W (SEOUL SEMICONDUCTOR)
4. LUMINOUS FLUX : 900\*6 lm
5. LENS : ACRYLIC
6. WEGHT : 2.05Kg
7. VIBRATION : 8.6Grms
8. WEALTH PROOF & DUST RESISTANCE
9. TEMPERATURE : -40°C~85°C
10. LIFE : 50,000Hr
11. IP RATING : IP68

UNIT	mm	DRAWING	CHECK	APPROVAL	TITLE	<b>SATURN 6" LED LIGHT</b>
SCALE						
DATA	2009.06.15					
					DRAWING NAME	10W LED FLOOD BEAM





**SATURN 12" LED BAR LIGHT**



## SATURN MACHINE & WELDING ENGINEERING SPECIFICATIONS

12F-LED-BAR			
SPECIFICATIONS	INPUT VOLTAGE (Vdc)	DC 11-32V	
	AMPERAGE DRAW (A)	DC 12V	DC 24V
		5	2.5
	LED COUNT	20	
	WATTAGE (W)	60	
	LUMENS (lm)	3600	
	LENGTH (in)	12	
	HEIGHT (in)	2.75	
	DEPTH (in)	3	
	WEIGHT (lbs)	5	
	BEAM PATTERN	45 Degree Flood	
	COLOR TEMPERATURE (K)	7000	
	VIBRATION RATING (Grms)	8.6	
	OPERATING TEMPERATURE (F)	(-40 ~ 221)	
	IP RATING (IP)	67	
MATERIALS LIST	BODY	6061 Aluminum	
	END CAPS	6061 Aluminum	
	LENS	Soda Lime Glass	
	LENS COATING	IR Reflective	
	REFLECTOR	Metalized Polycarbonate	
	OPTICS	Acrylic	
	PC BOARD	Metal 1.6t	
	INPUT CONNECTOR (UNIT)	AI MS3102A14S-7PW	
	INPUT CONNECTOR (WIRE)	AI MS3106A14S-7SW	
	LENS SEAL	4.0 Silicon Clear	
	MOUNTING BRACKET	6061 Aluminum	
	MOUNT BUSHING	Silicon Black	



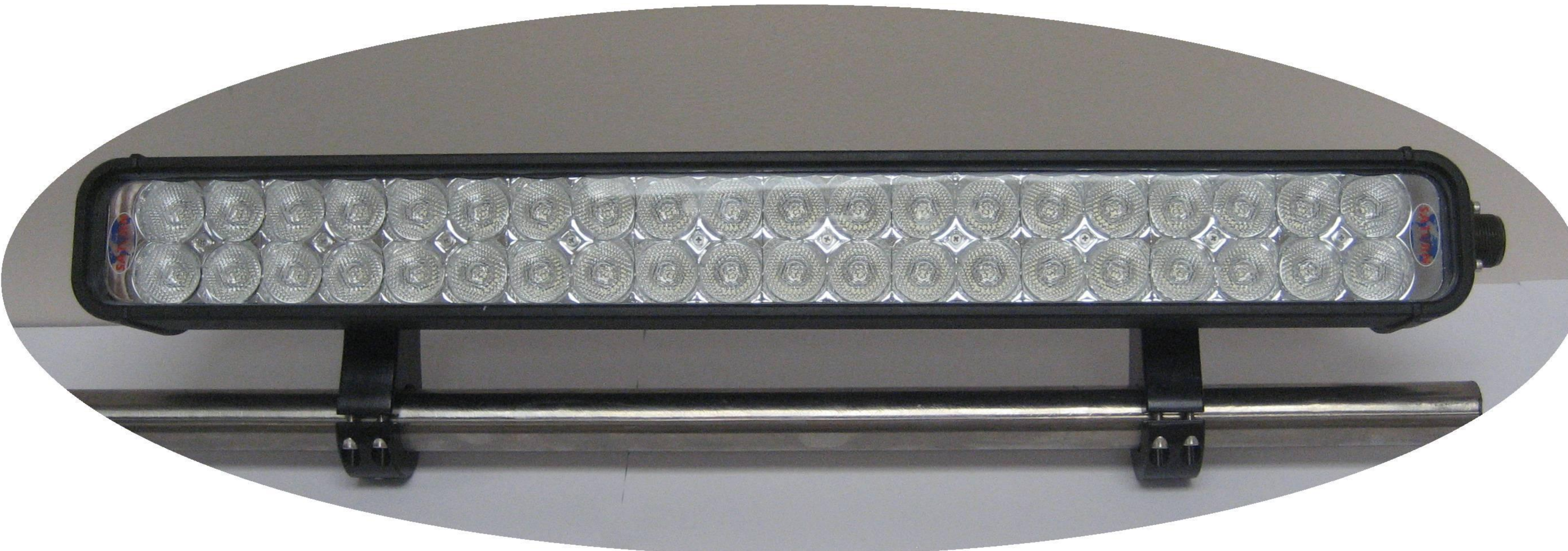

**SATURN'S 22" LED LIGHT**





## SATURN MACHINE & WELDING ENGINEERING SPECIFICATIONS

22F-LED-BAR			
SPECIFICATIONS	INPUT VOLTAGE (Vdc)	DC 11-32V	
	AMPERAGE DRAW (A)	DC 12V	DC 24V
		10	5
	LED COUNT	40	
	WATTAGE (W)	120	
	LUMENS (lm)	7200	
	LENGTH (in)	22	
	HEIGHT (in)	2.75	
	DEPTH (in)	3	
	WEIGHT (lbs)	9	
	BEAM PATTERN	45 Degree Flood	
	COLOR TEMPERATURE (K)	7000	
	VIBRATION RATING (Grms)	8.6	
	OPERATING TEMPERATURE (F)	(-40 ~ 221)	
	IP RATING (IP)	67	
MATERIALS LIST	BODY	6061 Aluminum	
	END CAPS	6061 Aluminum	
	LENS	Soda Lime Glass	
	LENS COATING	IR Reflective	
	REFLECTOR	Metalized Polycarbonate	
	OPTICS	Acrylic	
	PC BOARD	Metal 1.6t	
	INPUT CONNECTOR (UNIT)	AI MS3102A14S-7PW	
	INPUT CONNECTOR (WIRE)	AI MS3106A14S-7SW	
	LENS SEAL	4.0 Silicon Clear	
	MOUNTING BRACKET	6061 Aluminum	
	MOUNT BUSHING	Silicon Black	



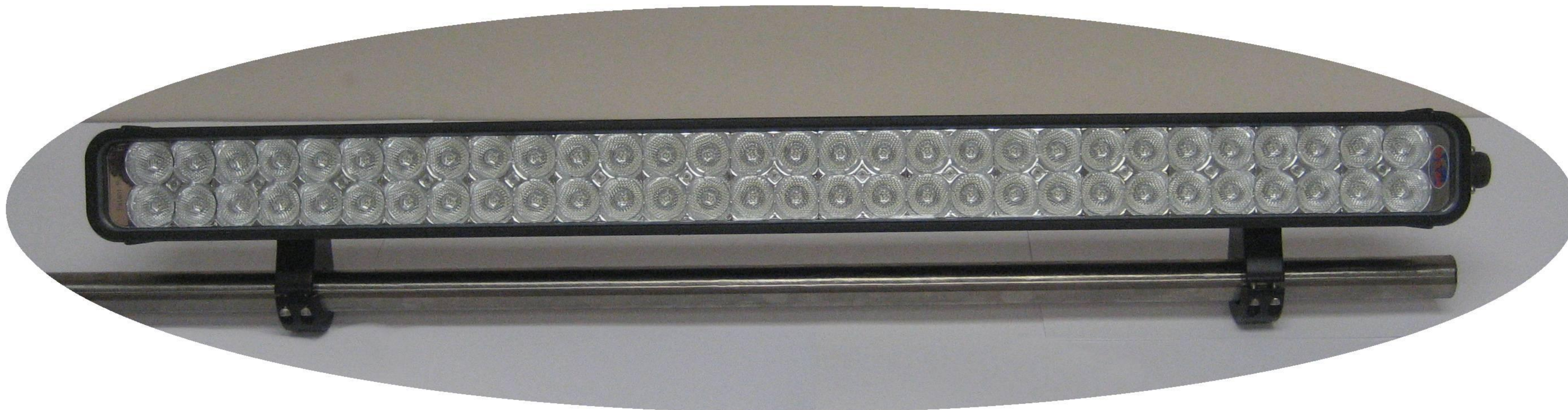

**SATURN'S 32" LED LIGHT**





## SATURN MACHINE & WELDING ENGINEERING SPECIFICATIONS

32F-LED-BAR			
SPECIFICATIONS	INPUT VOLTAGE (Vdc)	DC 11-32V	
	AMPERAGE DRAW (A)	DC 12V	DC 24V
		15	7.5
	LED COUNT	60	
	WATTAGE (W)	180	
	LUMENS (lm)	10800	
	LENGTH (in)	32	
	HEIGHT (in)	2.75	
	DEPTH (in)	3	
	WEIGHT (lbs)	13.1	
	BEAM PATTERN	45 Degree Flood	
	COLOR TEMPERATURE (K)	7000	
	VIBRATION RATING (Grms)	8.6	
	OPERATING TEMPERATURE (F)	(-40 ~ 221)	
	IP RATING (IP)	67	
MATERIALS LIST	BODY	6061 Aluminum	
	END CAPS	6061 Aluminum	
	LENS	Soda Lime Glass	
	LENS COATING	IR Reflective	
	REFLECTOR	Metalized Polycarbonate	
	OPTICS	Acrylic	
	PC BOARD	Metal 1.6t	
	INPUT CONNECTOR (UNIT)	AI MS3102A14S-7PW	
	INPUT CONNECTOR (WIRE)	AI MS3106A14S-7SW	
	LENS SEAL	4.0 Silicon Clear	
	MOUNTING BRACKET	6061 Aluminum	
	MOUNT BUSHING	Silicon Black	



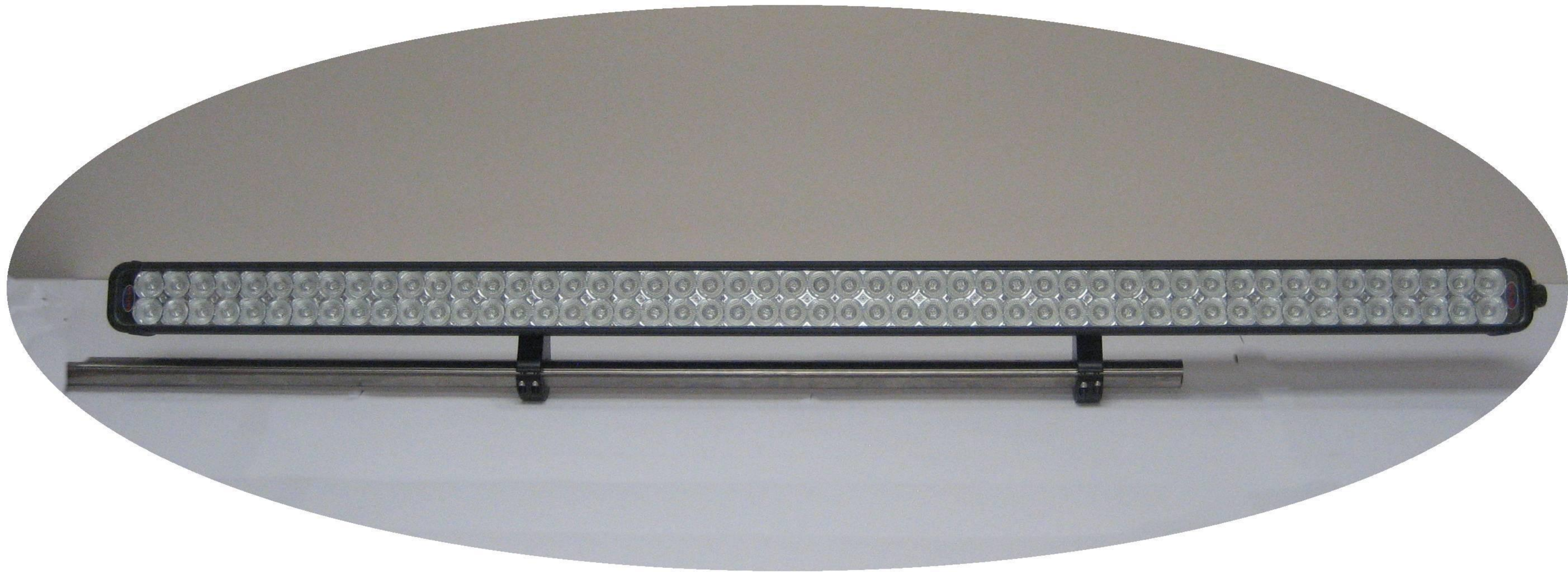

**SATURN 52" LED LIGHT**





## SATURN MACHINE & WELDING ENGINEERING SPECIFICATIONS

52F-LED-BAR			
SPECIFICATIONS	INPUT VOLTAGE (Vdc)	DC 11-32V	
	AMPERAGE DRAW (A)	DC 12V	DC 24V
		25	12.5
	LED COUNT	100	
	WATTAGE (W)	300	
	LUMENS (lm)	18000	
	LENGTH (in)	52	
	HEIGHT (in)	2.75	
	DEPTH (in)	3	
	WEIGHT (lbs)	19	
	BEAM PATTERN	45 Degree Flood	
	COLOR TEMPERATURE (K)	7000	
	VIBRATION RATING (Grms)	8.6	
	OPERATING TEMPERATURE (F)	(-40 ~ 221)	
	IP RATING (IP)	67	
MATERIALS LIST	BODY	6061 Aluminum	
	END CAPS	6061 Aluminum	
	LENS	Soda Lime Glass	
	LENS COATING	IR Reflective	
	REFLECTOR	Metalized Polycarbonate	
	OPTICS	Acrylic	
	PC BOARD	Metal 1.6t	
	INPUT CONNECTOR (UNIT)	AI MS3102A14S-7PW	
	INPUT CONNECTOR (WIRE)	AI MS3106A14S-7SW	
	LENS SEAL	4.0 Silicon Clear	
	MOUNTING BRACKET	6061 Aluminum	
	MOUNT BUSHING	Silicon Black	



**SPECIFICATION**

1. OPERATING VOLTAGE FREE VOLTAGE: DC 11.0V~32.0V
2. LED : 3W(750Ma)
3. REFLECTOR : PC / VACUUM METALLIZED
4. LENS : SODA LIME GLASS
5. VIBRATION : 8.6GRMS
6. WEATHER PROOF & DUST RESISTANCE
7. TEMPERATURE : -40F~221F
8. LIFE : 50,000 Hrs
9. IP RATING : IP67

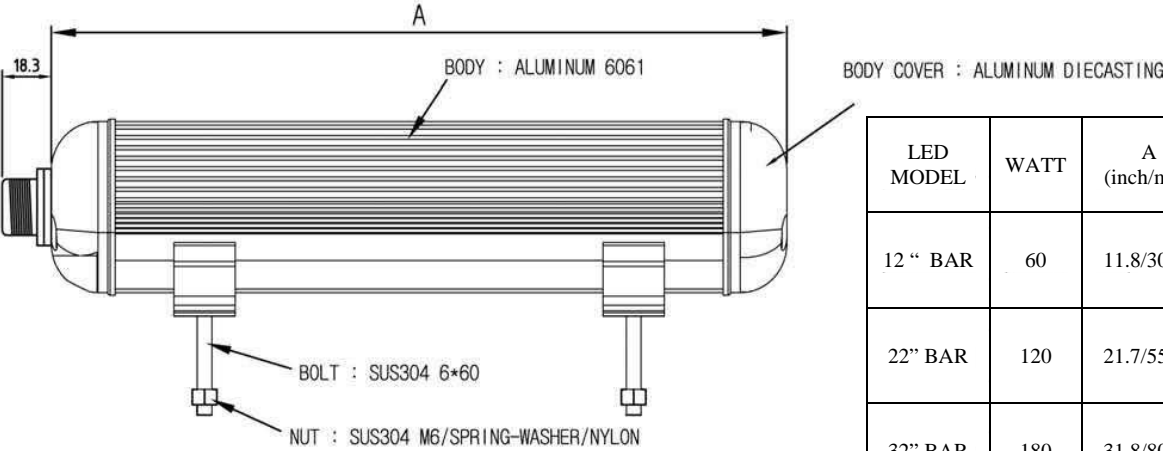
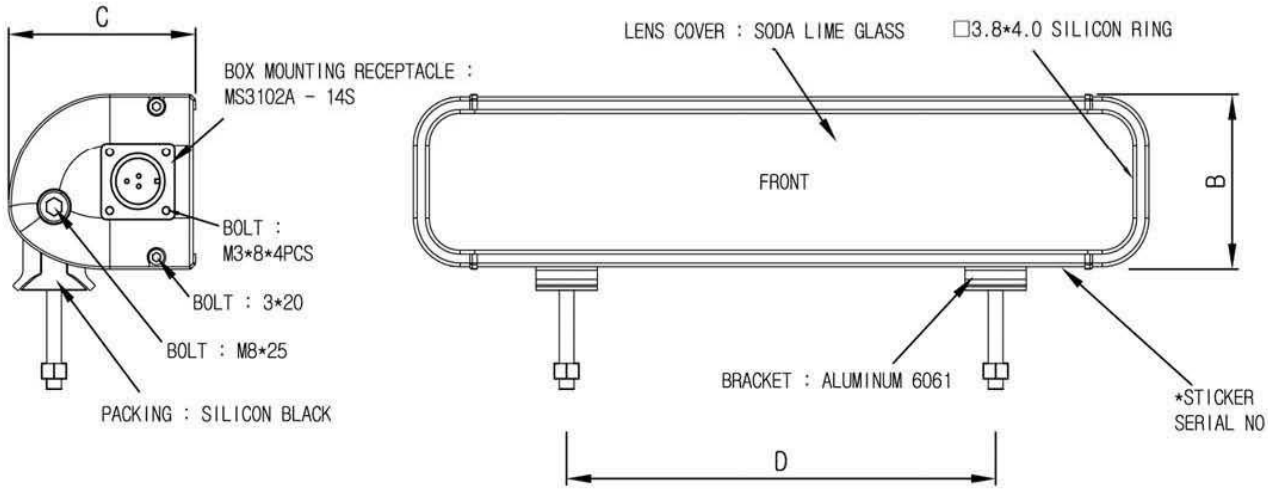

LED MODEL	WATT	A (inch/mm)	B (inch/mm)	C (inch/mm)	D (inch/mm)	WEIGHT (lbs)	PART #
12" BAR	60	11.8/300.0	2.7/69.0	3.0/76.25	4.92/125	3.65	12F-LED-BAR
22" BAR	120	21.7/550.0			5.0/127	6.62	22F-LED-BAR
32" BAR	180	31.8/808.0			8.35/212	9.60	32F-LED-BAR
52" BAR	300	51.8/1316.0			11.65/296	15.60	52F-LED-BAR

UNIT	mm	DRAWING	CHECK	APPROVAL	TITLE	<b>SATURN LED LIGHT BAR</b>
SCALE	2:1					
CREATED	02/19/2009					
SATURN MACHINE					DRAWING NO	







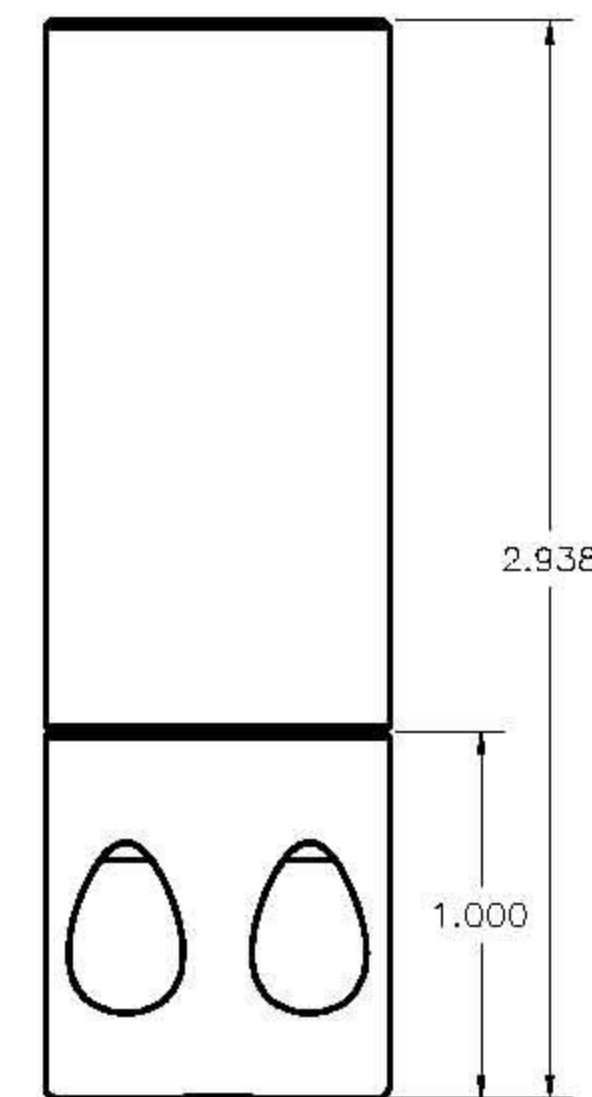
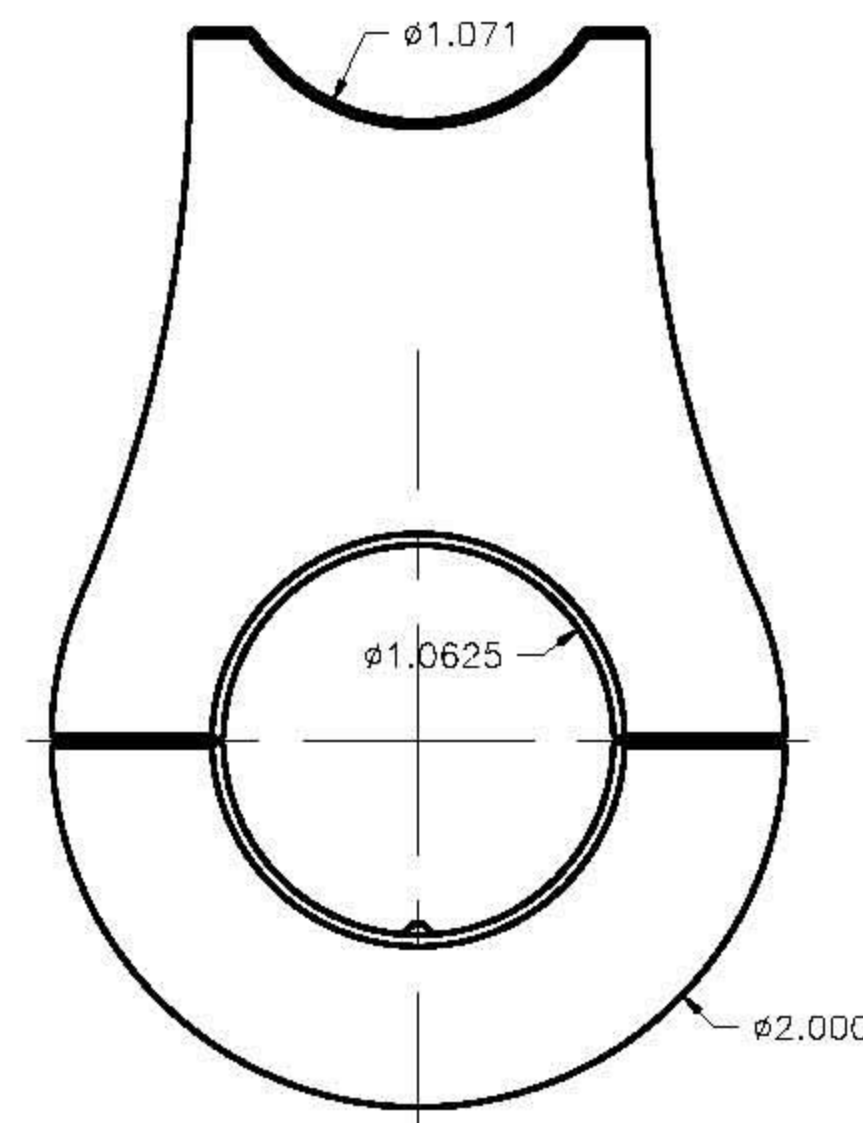
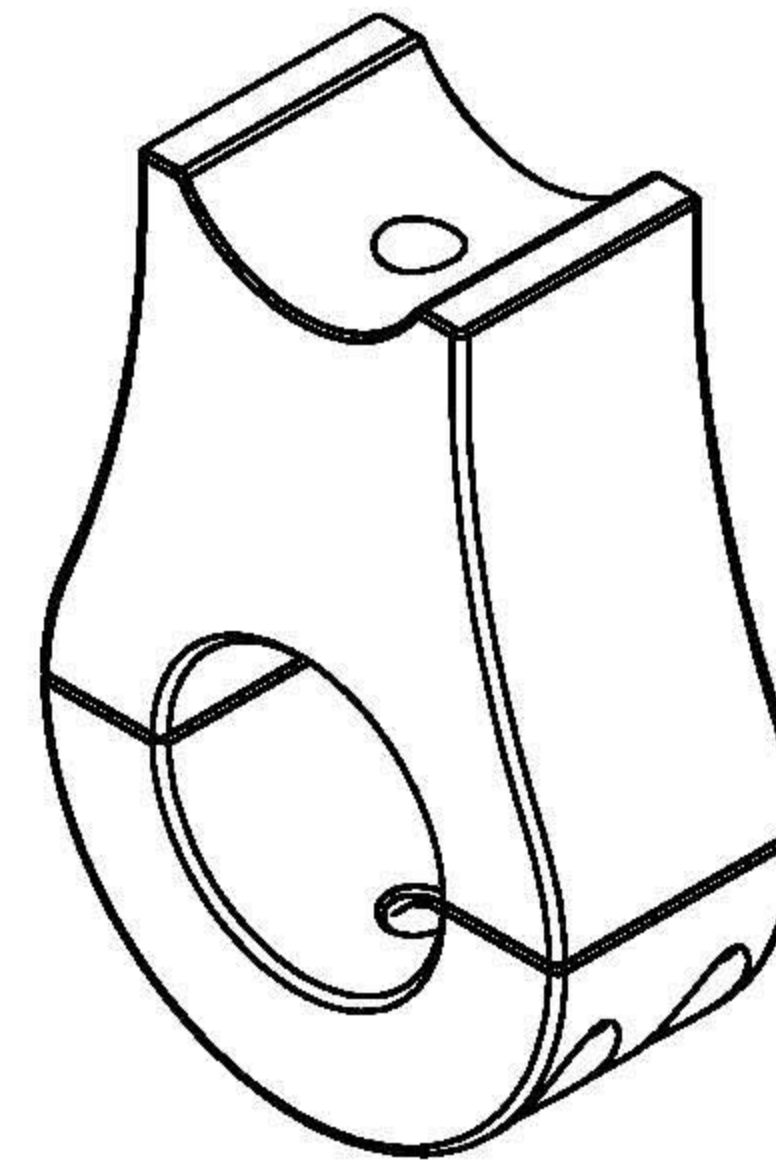
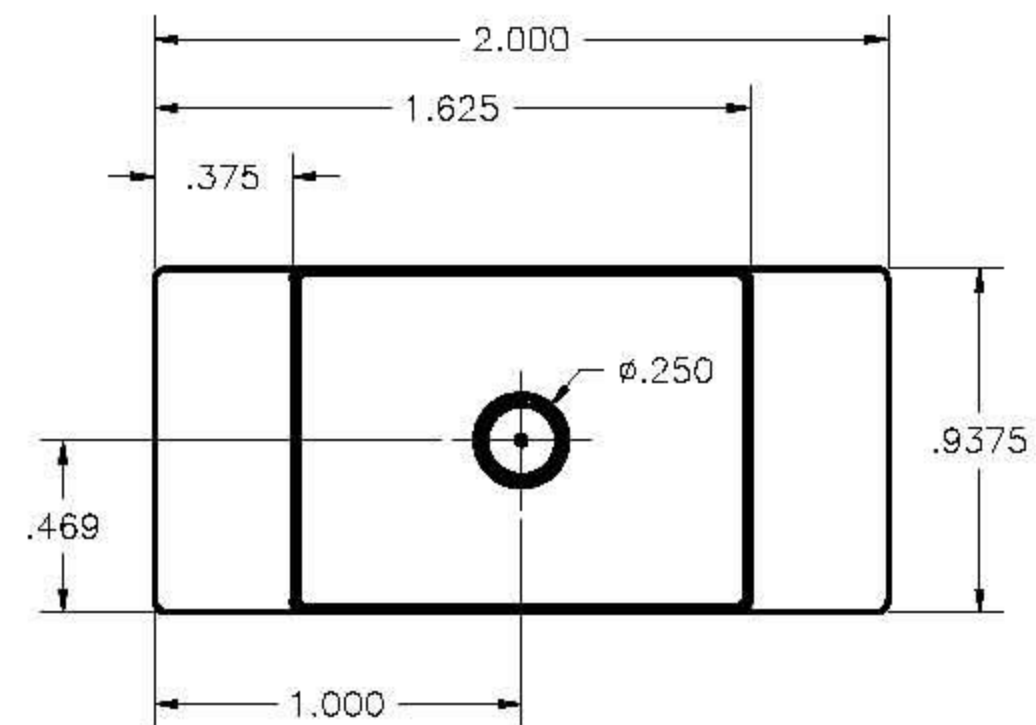

### Saturn Machine Conduit Clamp



FINISHES (U.O.N.) <sup>xxx</sup>	
MACHINED SURFACES:	125
DRILLED SURFACES:	250
SAWCUT SURFACES:	250
BURNED SURFACES:	500
UNMARKED SURFACES:	AS MILL SUPPLIED

TOLERANCES (U.O.N.)	
1. DECIMALS (.XXX):	±.003"
2. DECIMALS (.XX):	±.01"
3. FRACTIONS:	±1/16"
4. CONCENTRICITY:	.010" T.I.R.
5. PARALLELISM & SQUARENESS:	±1/2 DEGREE
6. ANGULARITY (INCL. BENT):	±1/2 DEGREE

THE PROPRIETARY RIGHTS TO ALL EQUIPMENT SHOWN ON THIS DRAWING ARE THE PROPERTY OF SATURN MACHINE & WELDING CO., INC. THE INFORMATION REGARDING SUCH EQUIPMENT AS SHOWN HEREON IS DISCLOSED IN CONFIDENCE TO AUTHORIZED PERSONS ONLY. UNAUTHORIZED DISCLOSURE IS PROHIBITED.

**SATURN**  
MACHINE & WELDING CO., INC.  
STURGIS AIRPORT  
STURGIS, KENTUCKY

**Conduit Clamp**

SATURN JOB # <sup>XX</sup>/<sub>XX</sub>  
SATURN SHEET #  
1502-XXXX  
CAD # 1502/1502XXXX

7				
6				
5				
4				
3				
2				
1				

PREPARED BY	DATE	CHECKED BY	DATE	SCALE
J.A.D.	05/01/09			1:16
PROJECT NO. -----				
JOB NO. -----				

RELEASED FOR:	<input type="checkbox"/> PRELIMINARY ISSUE	<input type="checkbox"/> CUSTOMER APPROVAL	<input checked="" type="checkbox"/> SHOP FABRICATION	<input type="checkbox"/> FIELD CONSTRUCTION	<input type="checkbox"/> AS BUILT	DATE: 05/01/09 BY: J.A.D.	DESTROY ALL PREVIOUS ISSUES!	REV.	DESCRIPTION	DATE	BY	CH'K.	JOB NO.
---------------	--	--	--	---	-----------------------------------	---------------------------	------------------------------	------	-------------	------	----	-------	---------



**2" SQUARE**





## SATURN MACHINE & WELDING ENGINEERING SPECIFICATIONS

2F-LED-POD			
SPECIFICATIONS	INPUT VOLTAGE (Vdc)	DC 9~50V	
	AMPERAGE DRAW (A)	DC 12V	DC 24V
		0.8	0.4
	LED COUNT	1	
	WATTAGE (W)	10	
	LUMENS (lm)	900	
	LENGTH (in)	2	
	HEIGHT (in)	2	
	DEPTH (in)	3.25	
	WEIGHT (lbs)	1	
	BEAM PATTERN	45 Degree Flood	
	COLOR TEMPERATURE (K)	7000	
	VIBRATION RATING (Grms)	8.6	
	OPERATING TEMPERATURE (F)	(-40 ~ 221)	
	IP RATING (IP)	68	
MATERIALS LIST	BODY	6061 Aluminum	
	FRONT COVER	6061 Aluminum	
	LENS	Soda Lime Glass	
	LENS COATING	IR Reflective	
	REFLECTOR	Metalized Polycarbonate	
	OPTICS	Acrylic	
	PC BOARD	Metal 1.6t	
	INPUT CONNECTOR (UNIT)	AI MS3102A10SL-3P	
	INPUT CONNECTOR (WIRE)	AI MS3106A10SL-3S	
	LENS SEAL	2.0 Silicon Clear	
		304SS	
	MOUNTING BRACKET	6061 Aluminum	



## SATURN MACHINE & WELDING LED LIGHTING

### LIGHTING TECHNOLOGY COMPARISONS

Unit	SATURN 6 in Round LED Qty (2)	SATURN 22 in Bar LED Qty (1)	Metal Halide 175 W Qty (1)	Incandescent 100 W Qty (5)
Light Output (Lumens)	10,800	7,200	8,800	7,500
Color Temp (See Chart)	7000K	7000K	4000K	3000K
Wattage	120	120	175	500
Lumens Per Watt	90	60	50	15
Electricity Cost Per Hour* (US Dollars)	0.8 cents Per Hour	0.8 cents Per Hour	1.2 cents Per Hour	3.5 cents Per Hour
Operating Life Span (Hours)	50,000	50,000	15,000	750

\*Based on Electricity Rate of 6.84 cents per kwh (National Average Industry Rate March 2009)

### Colour Temperatures in the Kelvin Scale

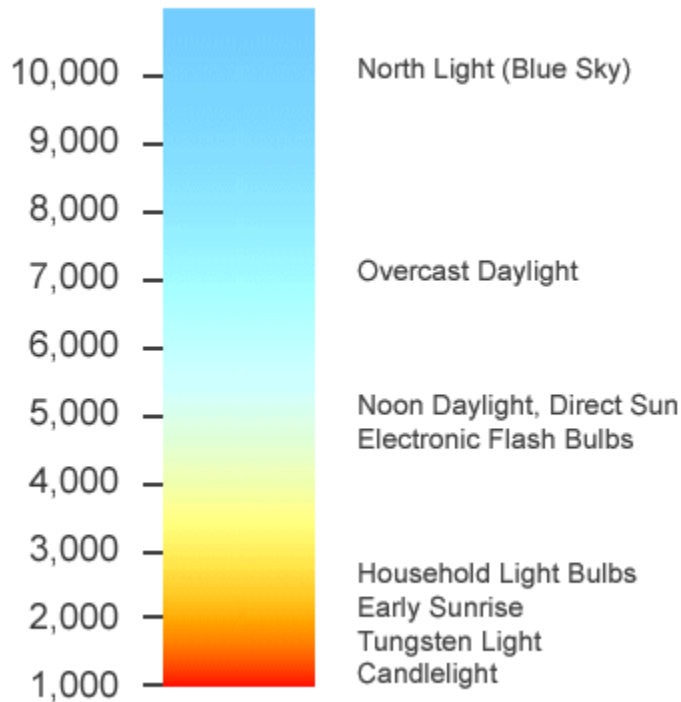

Image courtesy of [www.mediacollege.com](http://www.mediacollege.com)



Billy C. Baird, Chairman  
Charles Lynch, President



Phone: 270-333-2104  
Fax: 270-333-6909

## **SATURN MACHINE & WELDING CO., INC.**

**223 Willie Pride Rd. \* P.O. Box 69 \* Sturgis, Kentucky 42459**

### **DESIGNERS AND MANUFACTURES OF COKE OVEN EQUIPMENT**

Visit us at [www.cokeovenequipment.com](http://www.cokeovenequipment.com)

Email: [charles@saturnmachine.net](mailto:charles@saturnmachine.net)

## **WARRANTY SATURN SPECIALTY LIGHTING**

I

Saturn Machine lighting is backed with a full 2.5 year limited warranty. Saturn Machine warrants the replacement of faulty components due to defects in material and/or workmanship.

The warranty applies under the following conditions:

1. Proof of Purchase is required to validate warranty and is valid from the original date of purchase.
2. Defects, deterioration, non-conformance, or wear caused by misuse, abuse, abrasive action and wear or excessive heat shall not constitute or be considered defects in materials and workmanship and not covered under this warranty.
3. Saturn Machine will not be responsible for any expenses incurred, including but not limited to, materials and labor incurred as a result of damage through neglect, mishandling, improper or lack of maintenance, deliberate acts of vandalism or sabotage.
4. Saturn Machine will also not be responsible for any expenses incurred, including labor and material resulting from alterations made to the light fixtures and its components supplied by Saturn.
5. Broken glass is not covered under warranty.
6. Warranted items will be repaired to working condition and returned without cosmetic alterations.
7. Non-warranted items can be repaired at the customers' expense of parts and labor at the discretion of Saturn Machine, who will provide and estimated repair cost before proceeding with the repair.

II

The total responsibility of Saturn Machine for claims, losses, court costs, attorney fees, expenses, professional fees, liabilities or damages, whether in contract or tort, arising out of or related to the use or sale of its products shall not exceed the purchase price of the product alleged or found to be defective. In no event shall Saturn be liable for any indirect, incidental or consequential damages of any character, including, but not limited to, loss of use of productive facilities or equipment, lost profits, property damage, expenses incurred in reliance on the performance of Saturn, or lost production, whether suffered by purchaser or any third party. All claims of any nature whatsoever arising out of the operation and use of Saturn Specialty Lighting or any part thereof or claims involving any of the warranties or guarantees herein shall be construed by the laws of the Commonwealth of Kentucky.

Saturn does not authorize any person to create for it any other obligation or liability in connection with its Specialty Lighting and its components, assemblies, and systems. This document constitutes the entire warranty and guarantee and may not be orally altered or changed in any manner whatsoever.

**RETURN AUTHORIZATION:**

A return authorization must be obtained by contacting Saturn Machine by phone: 270-333-2104 or by email: [ben@saturnmachine.net](mailto:ben@saturnmachine.net).

Upon receipt of an authorization number, the fixture may be shipped to Saturn Machine to the following address. Please include the authorization number on the outside of the package.

Saturn Machine & Welding Co.  
LED Repair  
223 Willie Pride Road  
Sturgis, KY 42459

Following the above listed procedures will insure that your refurbished product is returned in approximately two weeks.



# SATURN SPECIALTY LIGHTING

## 2" SQUARE HIGH INTENSITY LED LIGHT *INSTALLATION INSTRUCTIONS*

**WARNING!** - Only use included wiring connector to wire the 2" square LED Light. Carefully follow the wiring diagram provided here. The 2" square light has unique circuitry that can easily be damaged if installer fails to follow the diagram provided. Only qualified persons should perform installation.

### PACKAGE CONTENTS:

- 2" Square LED Light
- Cable end connector
- Mount
- Horizontal connector
- Allen Wrench

### REQUIRED TOOLS:

- 1/4" Drill Bit
- 10mm Socket and Ratchet
- 10mm Open end wrench
- Soldering iron, solder and heat shrink
- Wire stripper
- Allen wrench (included)



### MOUNTING INSTRUCTIONS:

1. Drill 1/4" hole in desired mounting location. Note: the center of your hole will be the exact center of the light. Make sure to measure the location of your hole before drilling. Note: If you are linking multiple lights together using the included connector, carefully read linking instructions on the bottom of the next page before selecting placement of mounts.
2. Insert stud mount through the 1/4" hole and tighten the nylock nut with a 10mm socket or wrench to a maximum torque or 20ft/lbs. Note: DO NOT use air impact tool as the will damage the stainless threads.
3. Remove adjustment set screws if installed on adjustment bracket. Tighten the adjustment nylock snug against the bracket and aim the light to desired position. After the light is aimed, tighten the adjustment bolt and nylock to a maximum torque of 20 ft/lbs. If desired insert and hand tighten ad-

223 WILLIE PRIDE ROAD  
STURGIS AIRPORT  
STURGIS, KENTUCKY  
270-333-2104 (P)  
270-333-6909 (F)

# SATURN SPECIALTY LIGHTING

## 2" SQUARE HIGH INTENSITY LED LIGHT *INSTALLATION INSTRUCTIONS*

### WIRING INSTRUCTIONS:

The 2" Square LED Light draws 0.4 amps at 24 volts. Specialty heavy-duty DC rated light switches and high-temperature wiring is available. Wiring to be 12 gauge minimum.

1. Before making any connections, unplug all of the lights to avoid damaging the internal electronics.
2. Carefully follow the wiring diagram provided.
3. The connectors come with solder terminals. When soldering, make sure solder is well embedded into the copper strand.
4. After making your connections, heat shrink each individual connection to avoid shorting of wires and exposure of the copper to the elements.
5. With all of the connections made and insulated with heat shrink you can plug in and test.

**NOTE: Only qualified persons should perform wiring.**

**CAUTION: Use only with Class 2 Power Unit.**

### LINK SYSTEM:

The 2" Square High Intensity LED Light is equipped with a linking system which allows you to add or remove multiple types of mounts or link multiple lights together on any of its four (4) sides. It is recommended that two (2) mounts are used for every 12 inches of width when connecting lights. Rows of two (2) lights or higher may require an additional upper support mount.

1. To link multiple lights together, simply slide the provided link into the lights channels and hand tighten provided Allen bolts with the included Allen wrench.
2. It is recommended that you use a thread locking agent for high vibration situations.

**For additional information and pricing  
call 270-333-2104**

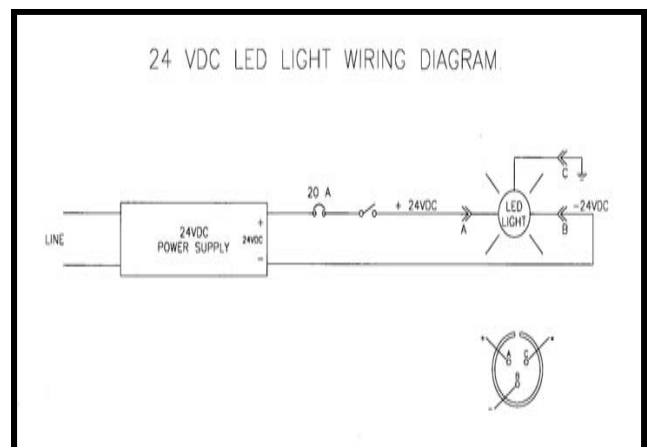

223 WILLIE PRIDE ROAD  
STURGIS AIRPORT  
STURGIS, KENTUCKY  
270-333-2104 (P)  
270-333-6909 (F)



# SATURN SPECIALTY LIGHTING

## HIGH INTENSITY LED BAR LIGHT INSTALLATION INSTRUCTIONS

Specialty heavy-duty DC rated light switches and high-temperature wiring is available. Wiring to be 12 gauge minimum.

1. Before making any connections, unplug all lights to avoid damaging the internal electronics.
2. Carefully follow the wiring diagram below.
3. The connectors come with solder terminals. When soldering, make sure solder is well embedded into the copper strand.
4. After making your connections, heat shrink each individual connection to avoid shorting of wires and exposure of the copper to the elements.
5. With all of the connections made and insulated with heat shrink you can plug in and test.

**NOTE: Only qualified persons should perform wiring.**

**CAUTION: Use only with Class 2 Power Unit.**

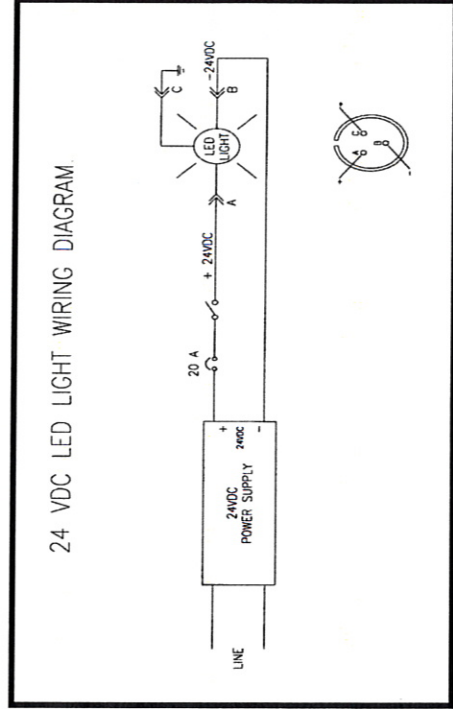

**For additional information and pricing,  
call 270-333-2104**

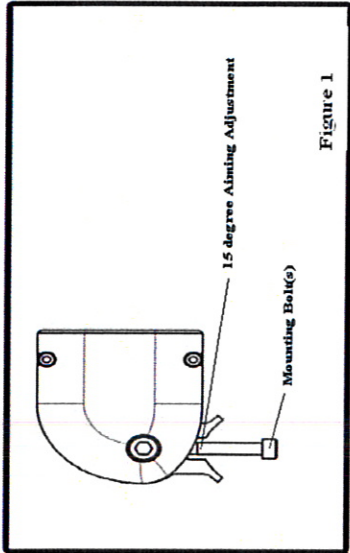

Figure 1

**WARNING!** Only use included wiring connector to wire the Bar LED Light. Carefully follow the wiring diagram provided here. The Bar Light has unique circuitry that can easily be damaged if installer fails to follow the diagram provided. Only qualified persons should perform installation.

### MOUNTING:

Mount light securely; making certain the bracket is square with vehicle. Tighten bolt on the bottom of the bracket to 50 ft/lbs.

### ADJUST LIGHT:

A good reference point is at 20 ft; the top of the beam should be 3" down from center of light ( with the light bar at dead center). Tighten light and enjoy.

### WIRING:

All electronics are internal, eliminating the need to mount external electronics. Every light has a simple 3 wire hook up.

### WIRING INSTRUCTIONS:

See Amperage Chart for LED Light Bars.

12F-LED-Bar	2.5 amps @ 24 volts
22F-LED-Bar	5 amps @ 24 volts
32F-LED-Bar	7.5 amps @ 24 volts
52F-LED-Bar	12.5 amps @ 24 volts



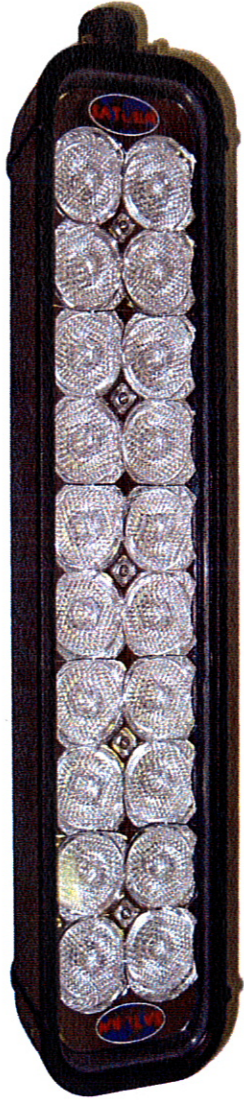

**SATURN LIGHT BAR WARNINGS:**

As with many other high-tech products, this LED Light Bar also requires some instruction before installing and using it. Please read the following information carefully!

- Do NOT stare directly into the light or shine directly into the eyes of another person as this may cause loss of vision.
- Never disassemble the product. All parts must be factory serviced to insure proper operation.
- Do NOT change the parts inside this light with parts from another company's product.
- Do NOT let water enter the housing. While **SATURN HIGH INTENSITY LED LIGHTS** are both weather and water resistant, it is not designed to be submersible.
- The light is designed to be mounted on the vehicle only in vertical or suspended positions.
- Do NOT allow objects or skin to touch a hot lens due to risk of burn.
- Installation and light change may only be performed by qualified individuals.
- The light must not adversely affect the performance of other equipment or the driver's vision.
- We recommend completely reading instructions prior to installation.

Also available for your light from Saturn Specialty Lighting:

- Additional Wiring Harnesses
- Aluminum Conduit Mounting Brackets (3/4" conduit)



**SATURN SPECIALTY LIGHTING**

223 WILLIE PRIDE ROAD  
STURGIS AIRPORT  
STURGIS, KENTUCKY

270-333-2104 (P)  
270-333-6909 (F)  
1-800-542-2512

# SATURN SPECIALTY LIGHTING

## HIGH INTENSITY LED BAR LIGHT INSTALLATION INSTRUCTIONS



# SATURN SPECIALTY LIGHTING

## 6" ROUND HIGH INTENSITY LED LIGHT *INSTALLATION INSTRUCTIONS*

**WARNING!** - Only use included wiring connector to wire the 6" Round LED Light. Carefully follow the wiring diagram provided here. The 6" round has unique circuitry that can easily be damaged if the installer fails to follow the diagram provide. Only qualified persons should perform installation.

### PACKAGE CONTENTS:

- 6" Round LED Light
- Wiring pigtail with connector
- Mount

### WIRING INSTRUCTIONS:

The 6" Round LED Light draws 2.5 amps at 24 volts. Specialty heavy-duty DC rated light switches and high-temperature wiring is available. Wiring to be 12 gauge minimum.

1. Before making any connections, unplug all of the lights to avoid damaging the internal electronics.
2. Carefully follow the wiring diagram provided.
3. The connectors come with solder terminals. When soldering, make sure solder is well embedded into the copper strands.
4. After making your connections, heat shrink each individual connection to avoid shorting of wires and exposure of the copper to the elements.

5. With all connections made and insulated with heat shrink, plug in and test.

**NOTE:** Only qualified persons should perform wiring.

**CAUTION:** Use only with Class 2 Power Unit.



24 VDC LED LIGHT WIRING DIAGRAM.

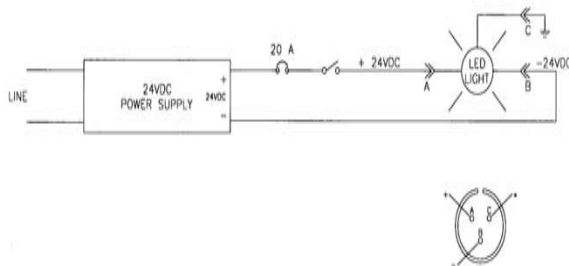

**For additional information  
and Pricing call  
270-333-2104.**

223 WILLIE PRIDE ROAD  
STURGIS AIRPORT  
STURGIS, KENTUCKY  
270-333-2104 (P)  
270-333-6909 (F)